

1) The Palace of Versailles was a hunting lodge located approximately 10 miles south of Paris. Draw a hunting lodge. Also draw directional signs on your graph and place a dot for Paris.

2) King Louis wanted a very large room that would not only be a meeting room (Hall of Mirrors) for his court, but also have chandeliers, mirrors, and artwork. Draw a large room that includes these items and make this the center of the home. Destroy the

hunting lodge and build the Hall of Mirrors. The Hall of Mirrors should be at the center of your drawing. This Hall is so important that nothing goes behind it.

3) The King and Queen wanted to be as close as possible to the Hall of Mirrors. Build them separate wings. The king even had a sunken bath tub with hot and cold running water. Draw two apartments one for the King (bath) and one for the Queen

that connects to the Hall of Mirrors.

4) To make sure that Louis could have access to anyone within an hour's time he built 350 apartments to house everyone. Each room dimension would depend on how important you were.

Design the apartment
creating various
dimensions for the
hierarchy of people in
court.

5) The King wanted to have open-air entertainment. Use fancy elaborate bricks to create the open-air royal courtyard that would allow everyone to use. Be sure to label Royal Courtyard.

6) The king wanted to have the beauty of the

outdoors all around him. His landscaper designed some of the most beautiful gardens in the world. Draw a garden on both sides of the Hall of Mirrors. The gardens were beautiful and magnificent in fact fragrances from the flowers were so strong people would get ill.

Also Included was a major technological innovation of the time --
- Pressurized water fountains. Include the two gardens, flowers, a person getting sick, and a fountain.

7) The king wanted to enjoy himself. He enjoyed opera, ballet, horseback riding, playing the guitar, fencing and billiards, and of course hunting. Religion was important to the king and he wanted to worship at Versailles.

Build a royal chapel, an opera house, stables, a music room, a room with fencing & billiards and a kennel.

8) He wanted to simulate war and military maneuvers so he built a

grand canal just west of the gardens for naval demonstrations. Draw a modest canal for naval simulations and draw small ships in the water.

9) At its height there were 20,000 people at Versailles. The king was overwhelmed and

needed a quiet place to work so he built a private retreat. Build the retreat away from the major buildings. Make it fit for a king and label private retreat.

10) Before the apartments construct a fence with a wide gate to signify nobility and

royalty live beyond the opening. Add gold and beauty to this fence.

11) He wanted his complete government at live at Versailles. Louis ordered the building of the War & Foreign Affairs Ministries both separate

buildings beyond the gate.

He also wanted a place for his officers to live.

Place this large building to the west of the gate and before the government buildings.

12) Add more gardens even to the back of the Hall of Mirrors for the 200,000 trees & 50

fountains (620 water jets)

13) Before the apartments construct a fence with a wide opening (don't create doors) to signify nobility and royalty live beyond the opening. Add gold

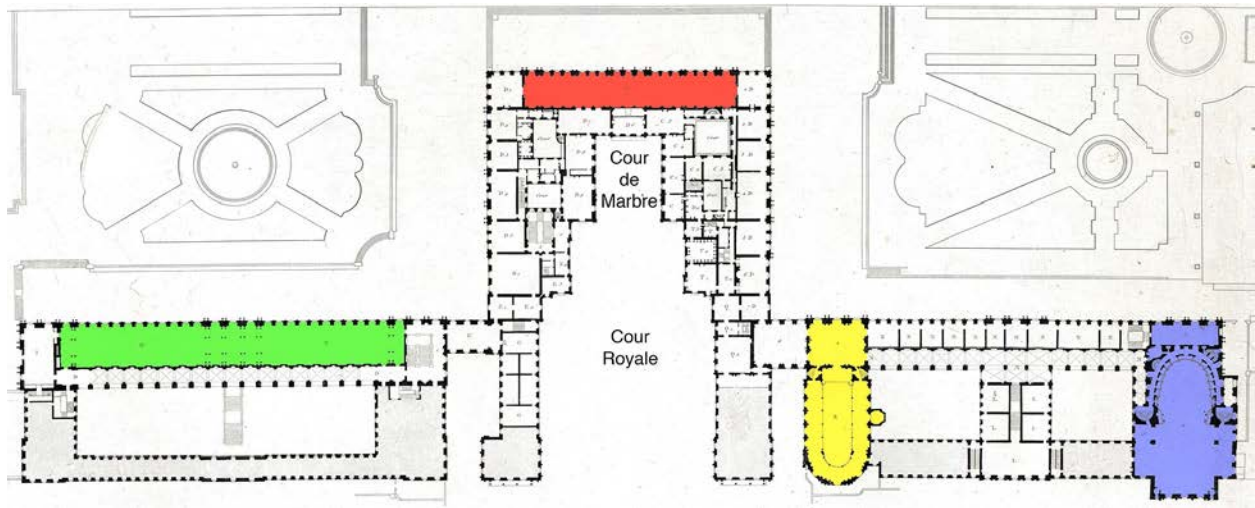
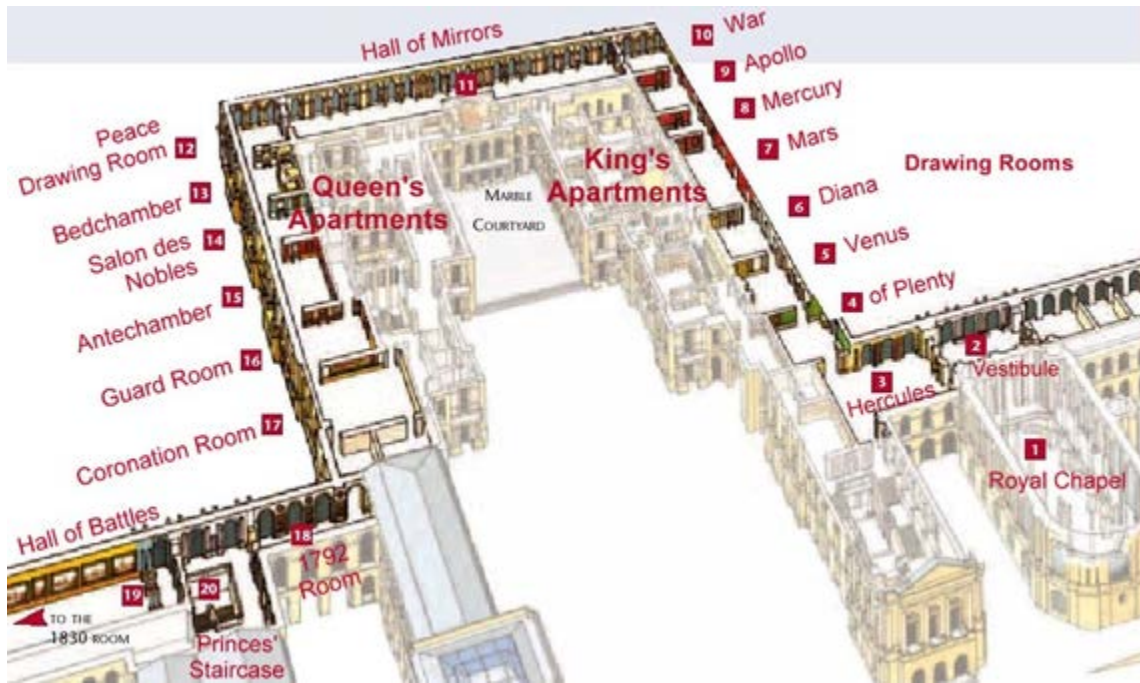

France during the Age of Absolutism ~ European style

What idea did the French monarchy believe in?
